



## PROJECT DESCRIPTION

### **Richmond High School is excited to introduce the Auxiliary Gym, Science Building and Student Quad!**

This project includes a new practice gymnasium building which also includes a girls' locker room, dance studio, and weight room, as well as the seismic upgrade and accessibility retrofit of the existing Science Classroom Building. An exciting new element is the addition of a student quad between the two buildings and leading towards the entry of the stadium, which will provide a place to gather and a setting for outdoor learning activities. The project is being delivered using the design-build method.



## UPCOMING CONSTRUCTION ACTIVITIES

Pending permit approval, the currently projected schedule is for the Contractor to begin mobilization and staging for the project in October 2019. Sitework for the new auxiliary gym will occur first and then construction of the building will immediately follow in the winter.

## PROJECT FACTS

**New Auxiliary Gym Square Footage:** 15,500

**Completion:** Construction is scheduled to start in the Fall of 2019. The Science Classroom Building is scheduled to be finished in the Summer of 2020, and the new Auxiliary Gym in the Winter of 2020.

**General Contractor:**  
Lathrop Construction Associates  
[www.lathropconstruction.com](http://www.lathropconstruction.com)

**Architect:**  
HKIT Architects  
[www.hkit.com](http://www.hkit.com)



Auxiliary Gymnasium

## Stay Tuned for Monthly Updates!

- Work Completed Each Month
- Upcoming Construction Activities
- Monitoring & Statistics
- Potential Impacts to Neighbors
- Message from the Construction Manager

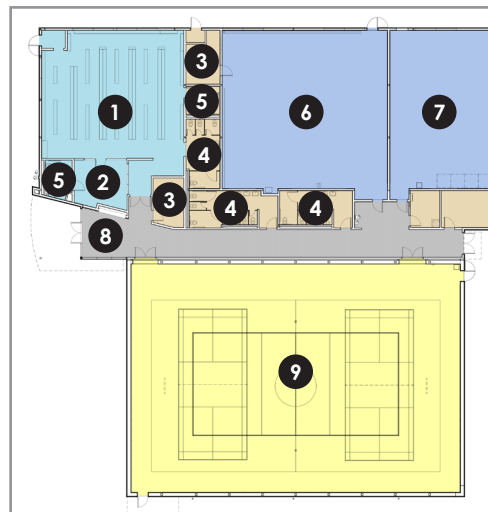

- 1 Lockers
- 2 Office
- 3 Storage
- 4 Restroom
- 5 Shower
- 6 Dance Studio
- 7 Weight Room
- 8 Corridor
- 9 Auxiliary Gymnasium

Floor Plan

## CONTACT INFORMATION

To subscribe to this monthly newsletter or to submit project questions, please email:  
Facilitiesplanning@wccusd.net

### Construction Manager

**Peter Hempel**

Project Manager

Swinerton Management & Consulting

415.516.1250



Site Plan