



Gym / Main Entry & Student Quad

PROJECT DESCRIPTION

Richmond High School is excited to introduce the Auxiliary Gym, Science Building and Student Quad!

This project includes a new practice gymnasium building which also includes a girls' locker room, dance studio, and weight room, as well as the seismic upgrade and accessibility retrofit of the existing Science Classroom Building. An exciting new element is the addition of a student quad between the two buildings and leading towards the entry of the stadium, which will provide a place to gather and a setting for outdoor learning activities. The project is being delivered using the design-build method.



Science Classroom Building



Building A to be Removed

UPCOMING CONSTRUCTION ACTIVITIES

In late July 2019, the Contractor will begin mobilization and staging and removal of the existing Building A, as well as sitework for the new auxiliary gym.

Work is projected to start on the buildings in the Fall.

PROJECT FACTS

New Auxiliary Gym Square Footage: 15,500

Completion: Construction is scheduled to start in the Summer of 2019. The Science Classroom Building is scheduled to be finished in the Summer of 2020, and the new Auxiliary Gym in the Fall of 2020.

General Contractor:

Lathrop Construction Associates
www.lathropconstruction.com

Architect:

HKIT Architects
www.hkit.com



Auxiliary Gymnasium

Stay Tuned for Monthly Updates!

- Work Completed Each Month
- Upcoming Construction Activities
- Monitoring & Statistics
- Potential Impacts to Neighbors
- Message from the Construction Manager

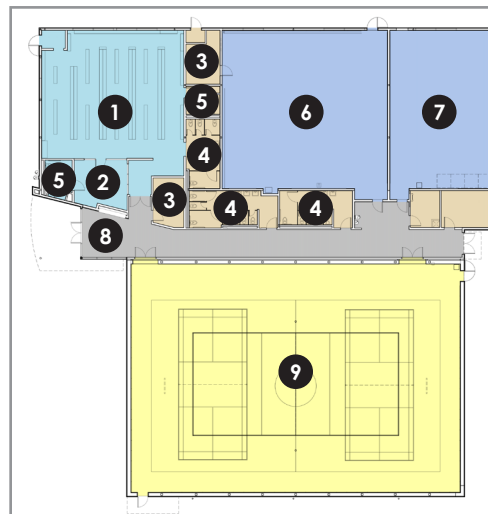

- 1 Lockers
- 2 Office
- 3 Storage
- 4 Restroom
- 5 Shower
- 6 Dance Studio
- 7 Weight Room
- 8 Corridor
- 9 Auxiliary Gymnasium

Floor Plan

CONTACT INFORMATION

To subscribe to this monthly newsletter or to submit project questions, please email:
Facilitiesplanning@wccusd.net

Peter Hempel

Project Manager
Swinerton Management & Consulting
415.516.1250



Site Plan